

Directions

Airport and Railway route Map to Kyoto International Conference Center (ICC Kyoto)

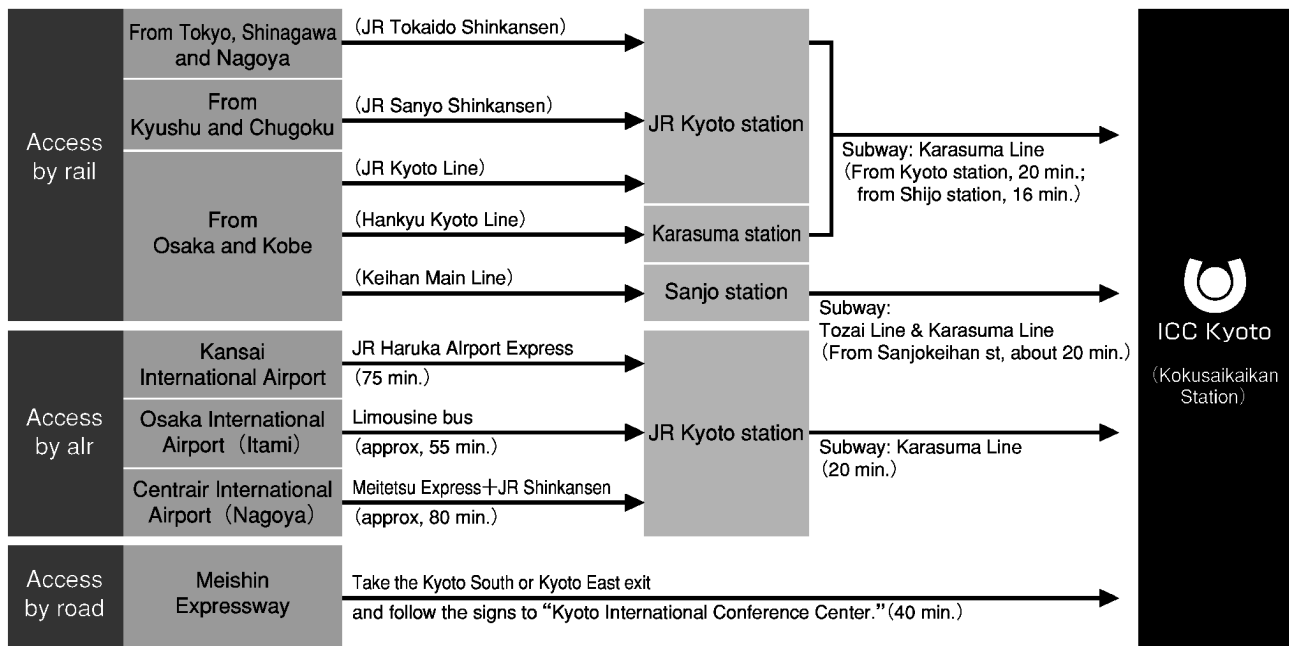
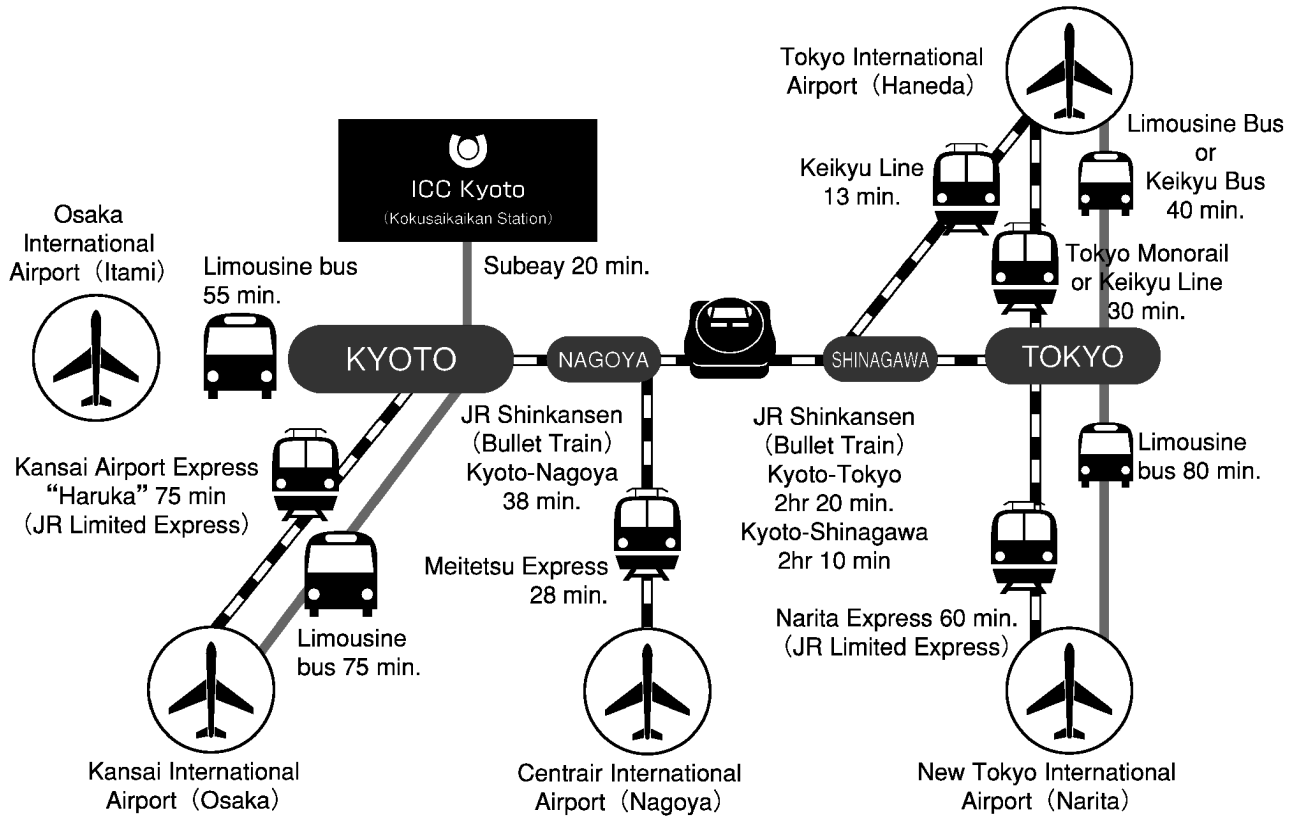

JSI Kyoto International Conference Center

1F



- | | | | |
|---------------------|----------|------------------------|----------------------|
| ■ Registration Desk | ■ Room G | ■ Speaker Center | ■ Cloak 1, 2, 3 |
| ■ Room A | ■ Room H | ■ Seminar Ticket | ■ Get Together Party |
| ■ Room B | ■ Room I | ■ Poster Exhibition | ■ Secretariat |
| ■ Room C | ■ Room J | ■ Equipment Exhibition | |

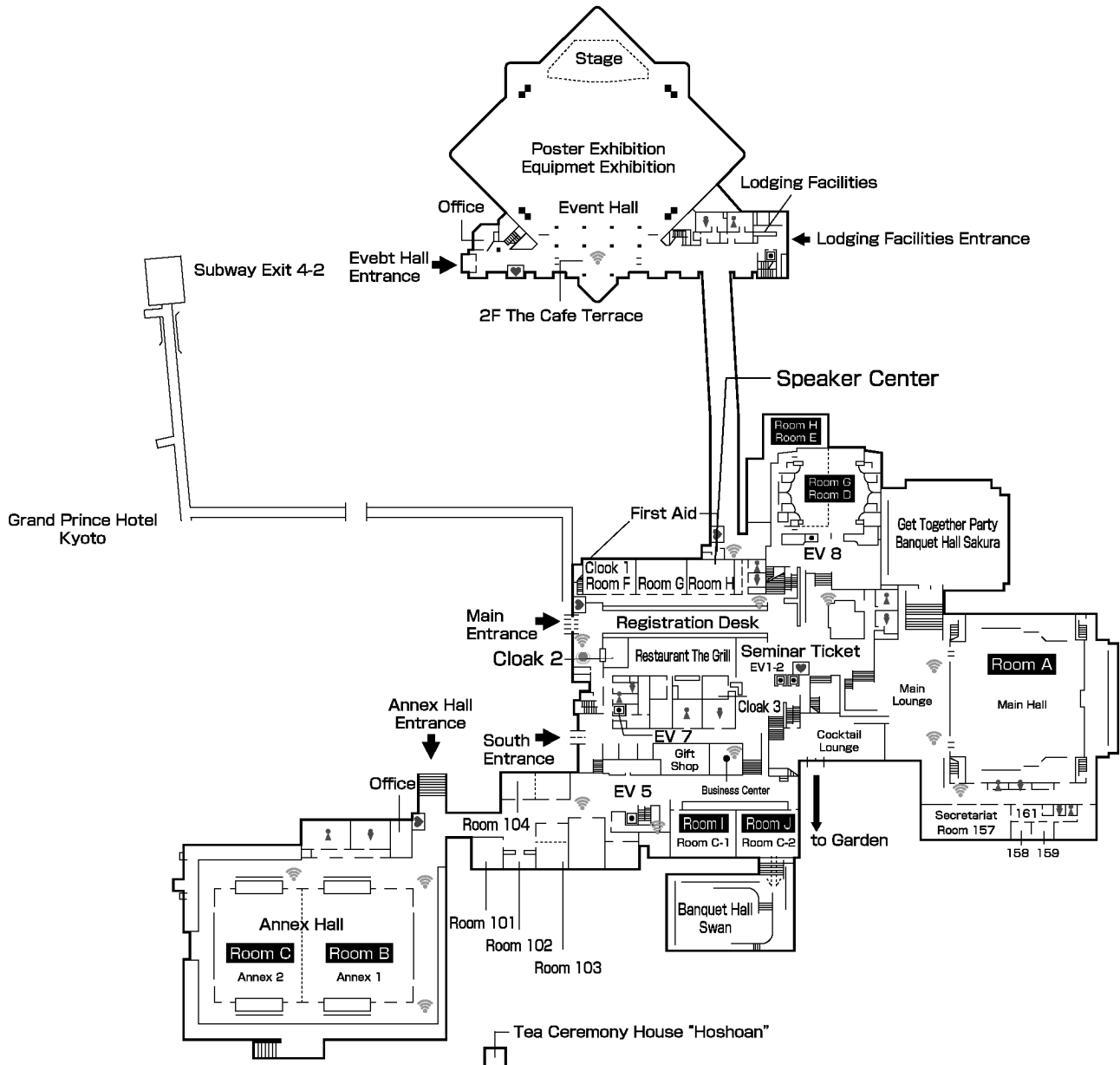

JSI Kyoto International Conference Center

2F

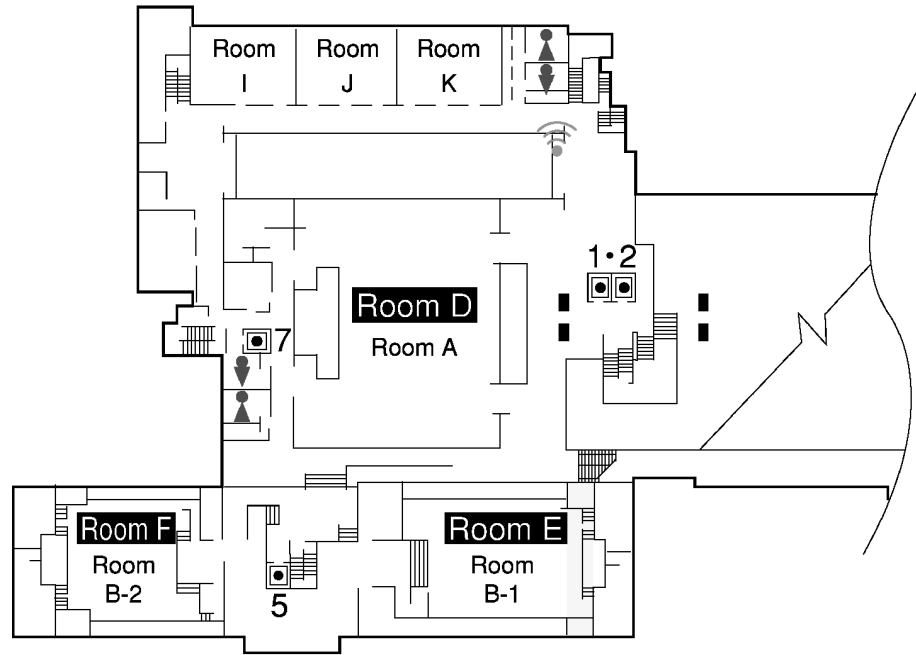

6F

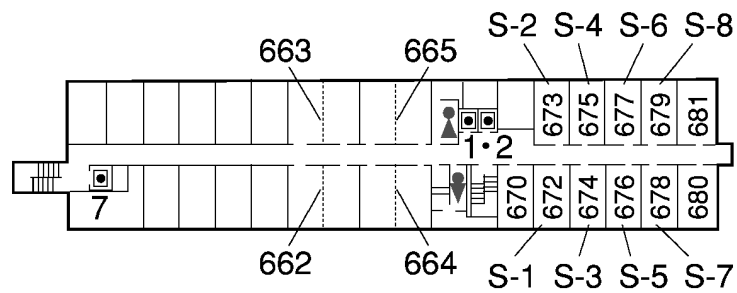

The 43rd Annual Meeting of The Japanese Society for Immunology Schedule

December 10 (Wed.)

オーバービュートーク (Overview Talk)	8 : 30 ~ 9 : 00	Room A, B, C, D
Symposium	9 : 00 ~ 11 : 30	Room A, B, C, D
Poster Exhibition, Discussion	8 : 00 ~ 18 : 30	Event Hall
Equipment Exhibition	10 : 00 ~ 18 : 30	Event Hall
関連分野セミナー (Lecture on Related Fields)	12 : 00 ~ 13 : 00	Room D, I
Technical Seminar	12 : 00 ~ 13 : 00	Room G, J
Clinical Seminar	12 : 00 ~ 13 : 00	Room E, F, H
Council Meeting	12 : 00 ~ 13 : 00	Room A
Workshop	13 : 20 ~ 16 : 15	Room B, C, D, E, F, G, H, I, J

December 11 (Thu.)

Symposium	8 : 30 ~ 11 : 00	Room A, B, C, D
Poster Exhibition, Discussion	8 : 00 ~ 19 : 10	Event Hall
Equipment Exhibition	10 : 00 ~ 19 : 10	Event Hall
関連分野セミナー (Lecture on Related Fields)	13 : 00 ~ 14 : 00	Room D, I
Technical Seminar	13 : 00 ~ 14 : 00	Room F, J
Clinical Seminar	13 : 00 ~ 14 : 00	Room B, G, H
General Meeting & Award Lecture	11 : 10 ~ 12 : 50	Room A
Workshop	14 : 10 ~ 17 : 00	Room B, C, D, E, F, G, H, I, J

December 12 (Fri.)

オーバービュートーク (Overview Talk)	8 : 30 ~ 9 : 00	Room A, B, C, D
Symposium	9 : 00 ~ 11 : 30	Room A, B, C, D
Poster Exhibition, Discussion	8 : 00 ~ 18 : 30	Event Hall
Equipment Exhibition	10 : 00 ~ 18 : 30	Event Hall
関連分野セミナー (Lecture on Related Fields)	12 : 00 ~ 13 : 00	Room F, I
Memorial Seminar	12 : 00 ~ 13 : 00	Room D
Technical Seminar	12 : 00 ~ 13 : 00	Room E
Clinical Seminar	12 : 00 ~ 13 : 00	Room G, H
Workshop	13 : 20 ~ 16 : 15	Room B, C, D, E, F, G, H, I

General Information

A. Registration

1. For those who paid by online registration and received a ID badge, please fill the ID badge and bring it to the meeting. If you forget to bring it, come to the Registration desk with your ID.
2. For on-site registration, please come to registration desk and pay registration fee (see below) and get a ID badge.

Registration fee does not include the proceedings.

You can buy the proceedings (JPY 6,000) at the JSI desk near to the Registration desk.

On Site Registration Fee

Member: JPY 12,000

Member, Student: JPY 3,000

Non-member: JPY 14,000

Non-member, Student: JPY 5,000

3. For Honorary and Distinguished members, please come to the General Information at the Registration desk.
4. Registration desk is open in the following hours:
Wednesday, December 10: 7:30–16:15
Thursday, December 11: 7:30–16:30
Friday, December 12: 7:30–16:00

B. Application and Annual Membership Fee

1. For those who want to join the JSI, please come to the JSI desk.

Application Fee: JPY 1,000

Annual Membership Fee

Member: JPY 9,000

Foreign Member: JPY 10,000

Student Member: JPY 3,000

Foreign student member: JPY 4,000

2. Please note that cash only for payment at the JSI desk.

C. The General Assembly

11:10–11:40, Dec. 11/Room A

D. Council Meeting

12:00–13:00, Dec. 10/Room A

E. Ceremonies & Lectures

Ceremonies and Lectures as given below will be held after the General Assembly in Room A on Dec. 11.

- Commendation Ceremony for JSI Meritorious Members
- JSI Award Ceremony and Lecture
- JSI Human Immunology Research Award Ceremony and Lecture
- JSI Women Immunologist Award Ceremony and Lecture
- JSI Young Investigator Award Ceremony
- Awardees Introduction for Ursula and Fritz Melchers Travel Award
- Awardees Introduction for Tadimitsu Kishimoto International Travel Award

F. Symposia

Scheduled is twelve sessions (S1-S12) by international speakers. For further information, see the program.

G. Poster and Workshop

All the papers are presented in poster session. Presentations in workshops are selected from the papers.

The language for presentation and discussion is English.
During poster session beverages will be served.

H. Overview Talks

Overview talks selected topics for students and those who are not specialized in the topics. Overview talks pick up a topic related to the following symposium session. This session will be presented in Japanese.

I. Seminar Ticket (include Lunch box)

1. You can enjoy lunch box during the seminars scheduled in lunch time. To get lunch box, you need to come to the Seminar ticket desk in front of restaurant “The Grill” and get a ticket beforehand. You need to have ID badge to get a ticket.
December 10: 7:30–11:10 (After 11:20, you may get Seminar ticket in front of each room if Seminar ticket is still left.)
December 11: 7:30–12:10 (After 12:20, you may get Seminar ticket in front of each room if Seminar ticket is still left.)
December 12: 7:30–11:10 (After 11:20, you may get Seminar ticket in front of each room if Seminar ticket is still left.)
2. With a ticket, you can get lunch box in front of a room for the seminar you choose after the following time.
December 10: 11:30–
December 11: 12:30–
December 12: 11:30–

J. Seminars

- Technical Seminar
- Clinical Seminar
- Lecture on Related Fields (This lecture will be presented in Japanese.)
- Memorial Seminar

Lunch box is available for you. To obtain Lunch box, see above.

K. Exhibition

Exhibition, Wireless LAN, and Drink Service are available at the Event Hall.

L. Photographing and recording

Photographing and recording is prohibited in symposia, workshops, and poster sessions. Please understand our policy, which helps presentation and discussion to be hot.